



Shen Zhen Yulongtong Electron Co.,LTD

Leaded Chip Attenuators

Model: RFR30N-250A2402C

### ◆ General Specifications

- ◆ Impedance: 50 Ω
- ◆ Power Rating: 250W
- ◆ Peak Power: 1000W (2μs pulse width, 10% duty ratio)
- ◆ Substrate Material: ALN
- ◆ Attenuation Value: 20dB/30dB
- ◆ Attenuation Tolerance: ±1dB
- ◆ Frequency: DC-2.2GHz
- ◆ Return Loss: ≥23dB
- ◆ Operating Temperature: -55~+150℃
- ◆ RoHS Compliant

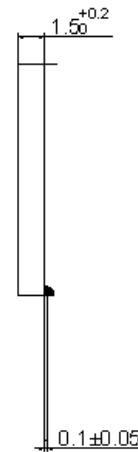
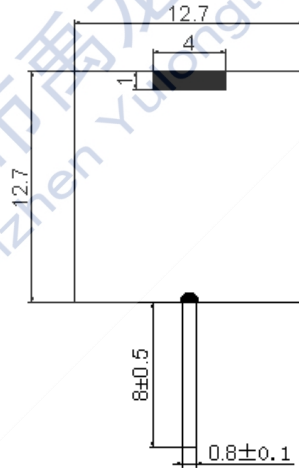

Tolerance unless otherwise specified: ±0.25mm

### Ordering Information

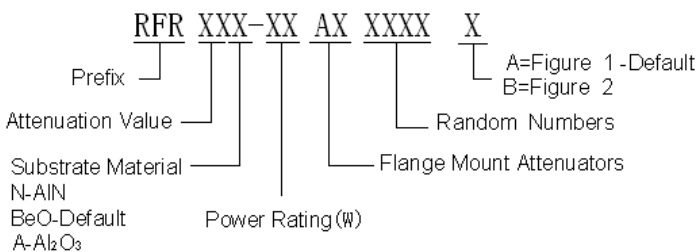

### Power Derating

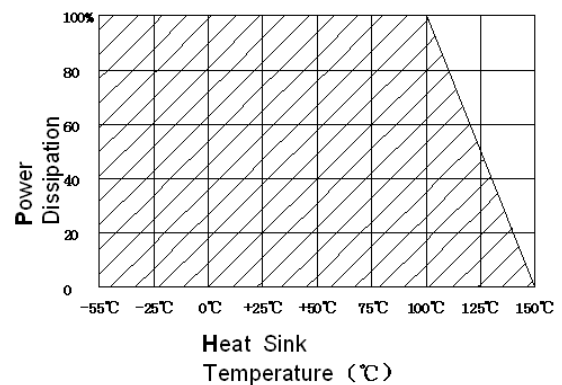

Tel: 86-755-26801033

web: [www.yulongtong.com](http://www.yulongtong.com)

email: [yulongtong@vip.163.com](mailto:yulongtong@vip.163.com)